

**SIDE VIEW**

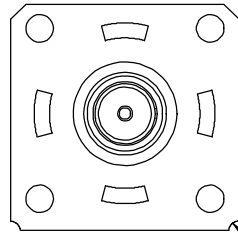

RADI AT BOTTOM

ITEM NO.	PART NUMBER	DESCRIPTION	QTY.
1	100-03214	AXLE TUBE	1
2	218-00013	SPINDLE W/FLANGE	2

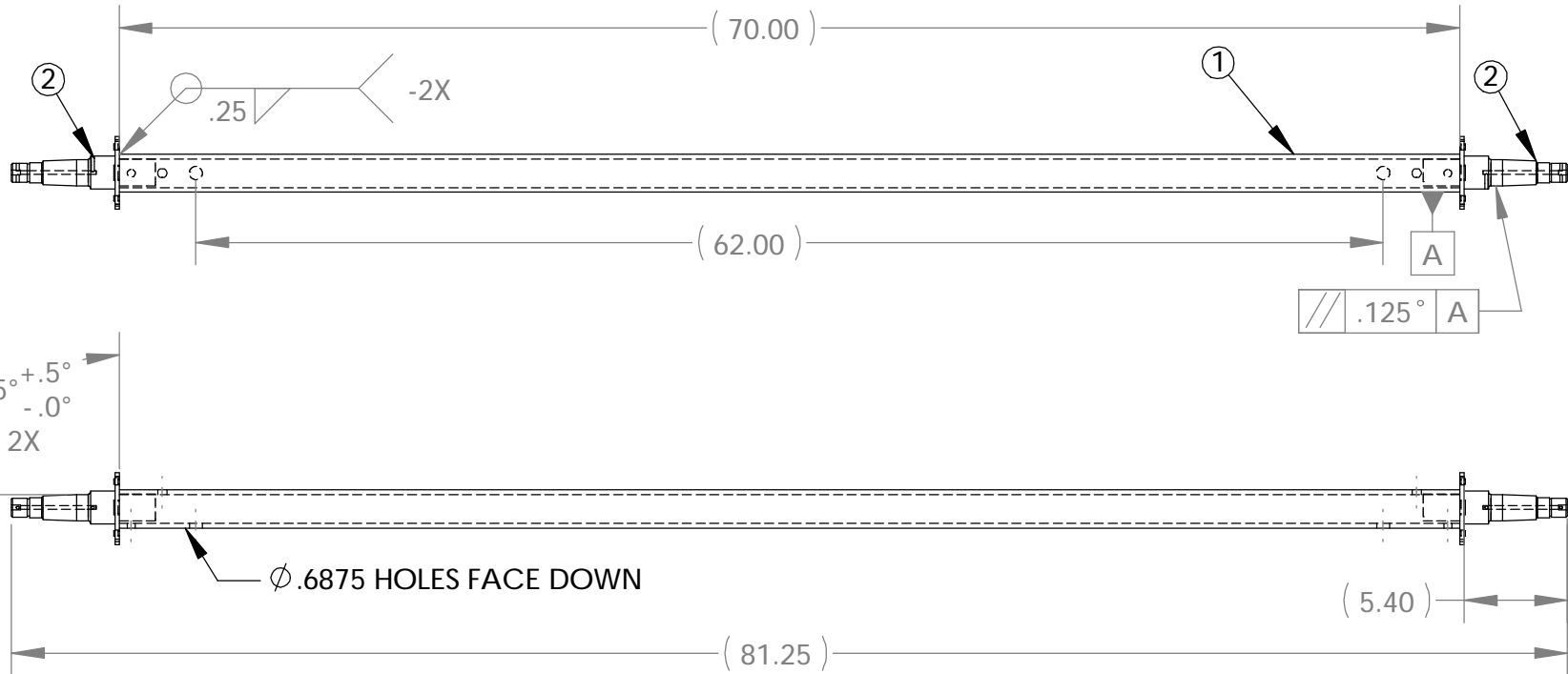

NOTES:  
1.) CAPACITY: 3750#

ALL DIMENSIONS ARE IN INCHES  
UNLESS OTHERWISE STATED  
TOLERANCES EXCEPT AS NOTED  
DECIMALS:  
.X ±0.100  
.XX ±0.060  
.XXX ±0.030  
.XXXX ±0.010

ANGLES:  
±1°  
ALL FORMED ANGLES  
EQUAL 90° UNLESS  
NOTED OTHERWISE

( ) INDICATES REFERENCE

THE INFORMATION IN THIS DRAWING IS THE SOLE  
PROPERTY OF KARAVAN TRAILERS, INC. ANY  
REPRODUCTION IN PART OR WHOLE WITHOUT  
THE WRITTEN PERMISSION OF KARAVAN TRAILERS,  
INC. IS PROHIBITED.

APPROVED BY:  
---  
DRAWN BY:  
*DON CASTLE*  
DATE: 04-24-08  
SHEET: 1 OF 1  
SCALE: N/A

**KARAVAN**  
TRAILERS

TITLE: AXLE WELDMENT  
MAT'L: SEE B.O.M.  
FINISH: -ZN  
DWG. #: **300-01940-A**

DWG. REV.	ECR/NDR NUMBER	REVISED BY	DATE	DESCRIPTION
A	14570	DLC	04-24-08	DRAWING CREATED

## First Piece - In Process Inspection Sheet

Vendor \_\_\_\_\_

Description: **Axle Weldment**

Part # **300-01940**

Rev. **A**

QA Approval: K. Boomsma

JOB# \_\_\_\_\_

Characteristic	Tol.	Method	Freq.	1st Piece	A/R	2	A/R	3	A/R	4	A/R	5	A/R	6	A/R	7	A/R	Inspected By:	
91.5° - 2X	+ .5° - .0°	Visual	Every piece																1 /
Use CF 132	NA	Visual	Every piece																2 /
Weld per print	NA	Visual	Every piece																3 /
Remove all visible weld spatter, every piece	NA	Visual	Document 4x per shift																4 /
																			5 /
																			6 /